

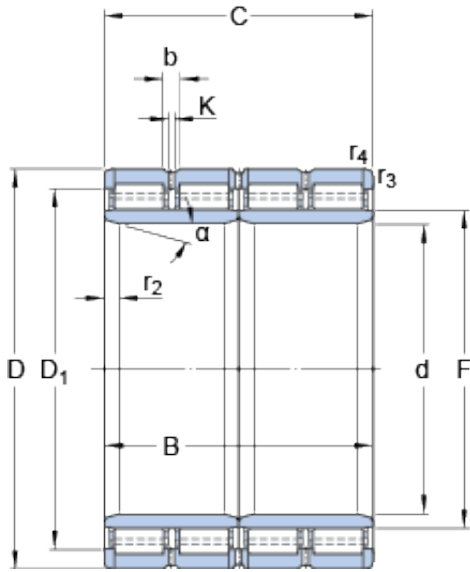

GF BEARING-SINGAPORE LTD.

700 mm x 930 mm x 620 mm skf 316967 Four-row cylindrical roller bearings

Bearing No. 316967



316967 Bearing 2D drawings and 3D CAD models

Size	930x700x620 mm
Bore Diameter	930 mm
Outer Diameter	700 mm
Width	620 mm
d	700 mm
D	930 mm
B	620 mm
C	620 mm
D ₁	864.2 mm
D ₁	864.2 mm
F	763 mm
b	22.3 mm
K	12 mm
r _{1,2} - min.	18 mm
	20 °
r _{3,4} - min.	3 mm
Basic dynamic load rating - C	16500 kN
Basic static load rating - C ₀	43000 kN
Fatigue load limit - P _u	3000 kN
Calculation factor - k _r	630
Mass bearing	1198 kg
Design variant/feature	BC4.10/W33WI
D ₁	864.2 mm
r _{1,2} min.	18 mm



GF BEARING-SINGAPORE LTD.

	20 °
$r_{3,4}$ min.	3 mm
Basic dynamic load rating C	16500 kN
Basic static load rating C_0	43000 kN
Fatigue load limit P_u	3000 kN
Calculation factor k_r	630